

- **Network Music & Announcement**
- **Integrated calendar scheduler**
- **Interface with conventional systems**
- **Comprehensive mix and match components**



Applications :

designed to easily distribute audio in a complex system, replacing conventional analogue PA system . It comes with fully automated features with calendar scheduler functions to broadcast audio like background music and pre-recorded audio messages to multiple zones at the same time. Live announcements are also possible when a microphone is connected to the system. Automatic playback of emergency evacuation announcements can when triggered by external devices such as fire alarm, smoke detectors and temperature sensors in future versions .

- **Shopping malls & complexes**
- **Airports, bus terminals & train stations**
- **Schools, colleges, universities**
- **Theme parks**
- **Museums**
- **Sports arena & stadiums**
- **Places of worships**
- **Multi dweller residential - condominium & apartments**

• APPLICATIONS



FIDS

DEPARTURES 10:32			
AIRLINE	FLIGHT	DESTINATION	TIME
RYANAIR	104	LONDON-STN	08:00
DELTA	134	NEWYORK-JFK	11:05
CONTINENTAL	25	NEWYORK-EWR	11:40
REX LIMOUS	125	DUBLIN	13:10
AMERICAN	AZ 787	DUBLIN	13:30
		CHICAGO	
BRITISH AIR	0175	LONDON-LGW	13:20
REX LIMOUS	5465	LONDON-LGW	13:20
REX LIMOUS	376	LONDON-LHR	13:35

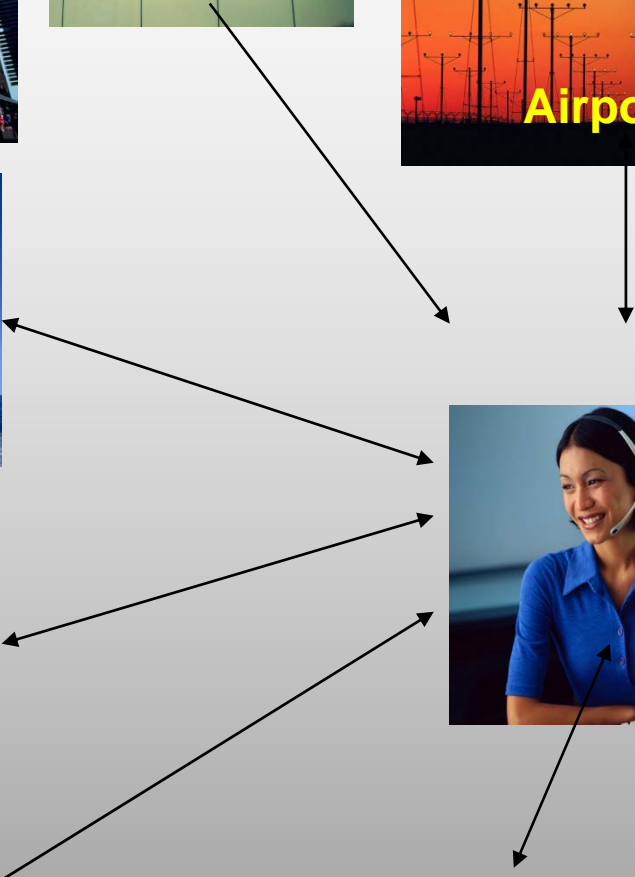

MAIN CONTROL SCREEN

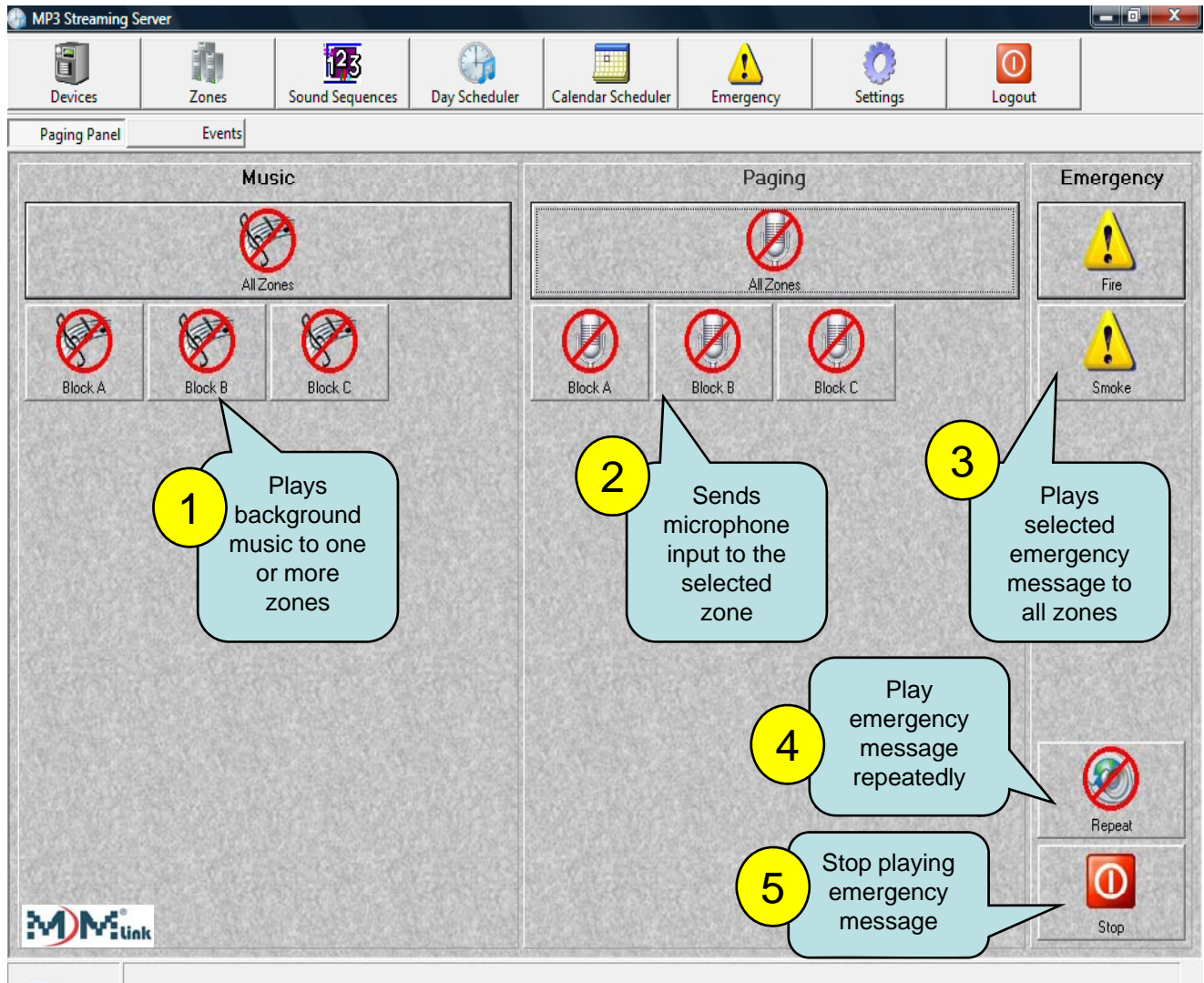

- 1 Background music zones selection
- 2 Microphone paging zones selection
- 3 Emergency evacuation message selection
- 4 Emergency evacuation message manual activation
- 5 Stop playback of evacuation message

CALENDAR SCHEDULER SCREEN

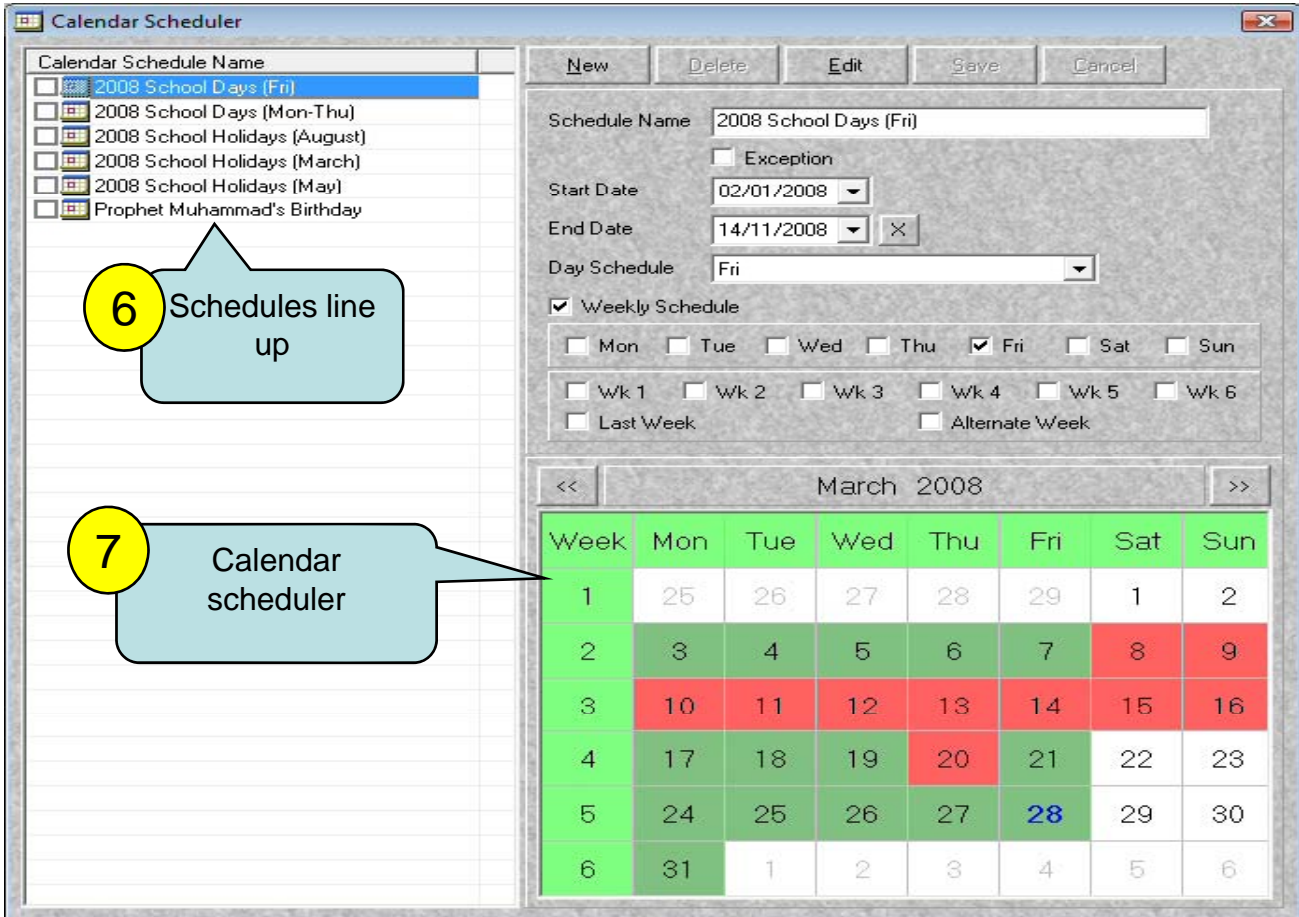

6 Rules by which the daily schedules are applied to days of the calendar

7 Graphical representation of the actual schedule with the rules applied.

- White indicates no events scheduled
- Dark green indicates events scheduled for that day
- Red indicates exceptions to the original schedule such as public holidays.

• APPLICATION EXAMPLE

Application example of a 4-storey 4-zones college

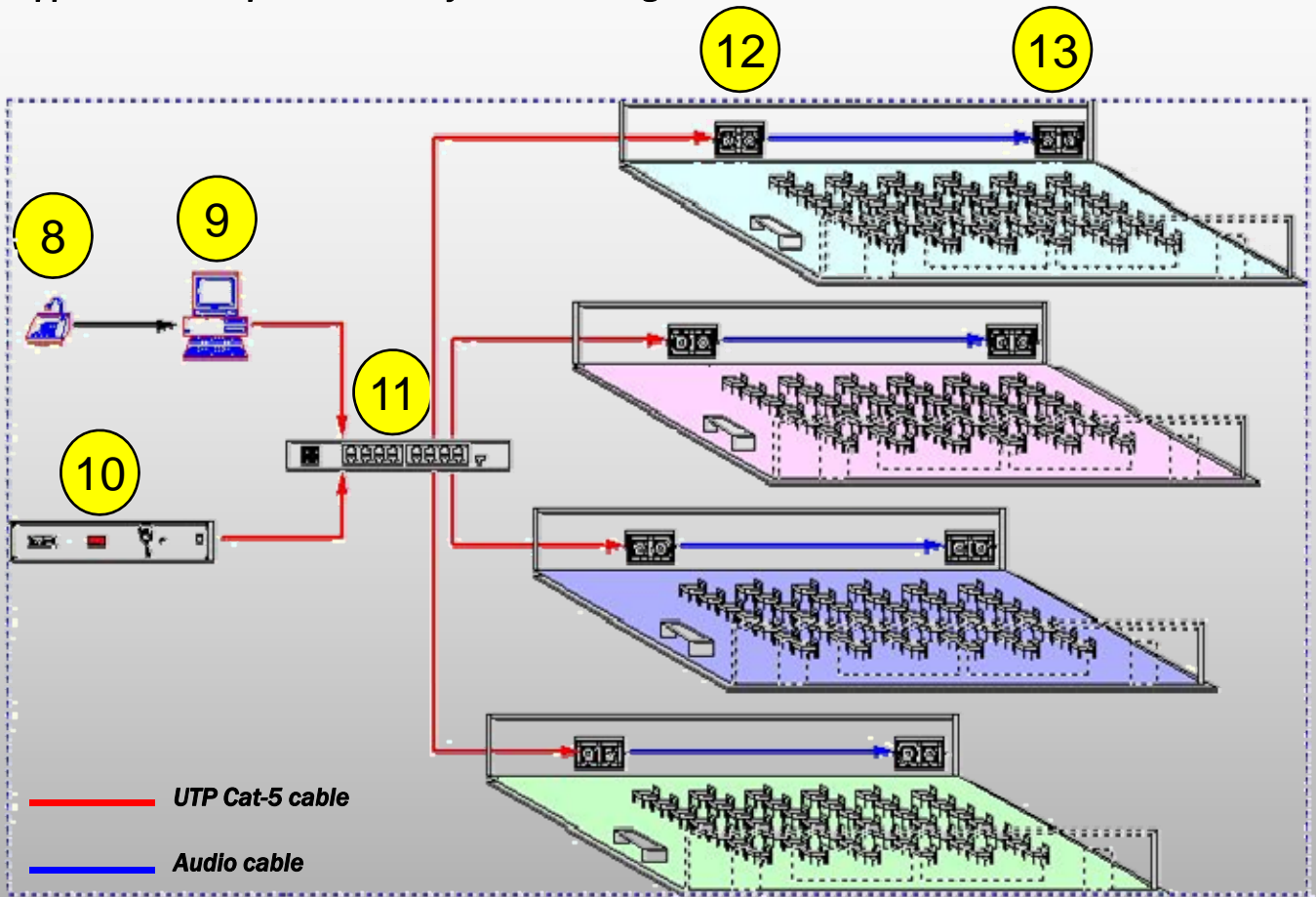

System components:

- 8 Desktop paging microphone
- 9 PC terminal with XA-4 system controller software
- 10 Fireman's emergency paging microphone
- 11 Standard 10/100 Mbits network switch
- 12 Vector-X PS-5022BX powered speaker
- 13 Vector-X PS-5021 Powered speaker

• **OUTPUT DEVICES**

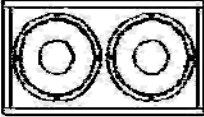
	<i>PS-5020</i>	<i>PS-5021</i>	<i>PS-5022BX</i>	<i>PS-5023PC</i>
Connector type	<i>RJ-45</i>	<i>3-pin XLR</i>	<i>RJ-45</i>	<i>RJ-45</i>
Network interface	<i>None</i>	<i>Analogue Audio input</i>	<i>Ethernet 10/100 Mbits</i>	<i>Ethernet 10/100 Mbits</i>
Mode of operation	<i>Interface with MX-1 mixer</i>	<i>Analogue audio</i>	<i>Interface with XA Series software</i>	<i>Stand alone or interface with XA Series software</i>
Built in power amplifier	<i>Class D PWM</i>	<i>Class D PWM</i>	<i>Class D PWM</i>	<i>Class D PWM</i>
Power output	<i>30 W x 2</i>	<i>30 W x 2</i>	<i>30 W x 2</i>	<i>30 W x 2</i>
Loudspeaker driver	<i>4.5" x 2 full range</i>	<i>4.5" x 2 full range</i>	<i>4.5" x 2 full range</i>	<i>4.5" x 2 full range</i>

• *OUTPUT DEVICES*

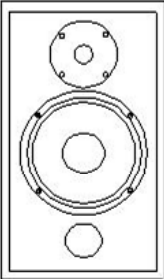
		<i>TS-8</i>	<i>TS-8BX</i>	<i>TS-8PC</i>	
				Connector type	4-pole Speakon
Network interface	Analogue Audio Input			Ethernet 10/100 Mbits	Ethernet 10/100 Mbits
Mode of operation	Analogue audio			Interface with XA Series software	Stand alone or Interface with XA Series software
Built in power amplifier	None			Twin Class D PWM	Twin Class D PWM
Power output	None			High : 100W Low : 150W	High : 100W Low : 150W
Crossover	Passive with Impedance correction			Optimized active crossover	Optimized active crossover
Loudspeaker driver	1" tweeter & 8" woofer			1" tweeter & 8" woofer	1" tweeter & 8" woofer

• *OUTPUT DEVICES*

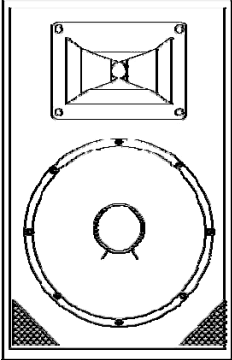
		<i>TS-12</i>	<i>TS-12BX</i>	<i>TS-12PC</i>	
				Connector type	4-pole Speakon
Network interface	Analogue Audio Input			Ethernet 10/100 Mbits	Ethernet 10/100 Mbits
Mode of operation	Analogue audio			Interface with XA Series software	Stand alone or Interface with XA Series software
Built in power amplifier	None			Twin Class D PWM	Twin Class D PWM
Power output	None			High : 100W Low : 250W	High : 100W Low : 250W
Crossover	Passive with Impedance correction			Optimized active crossover	Optimized active crossover
Loudspeaker driver	1" tweeter & 12" woofer			1" tweeter & 12" woofer	1" tweeter & 12" woofer

• *OUTPUT DEVICES*

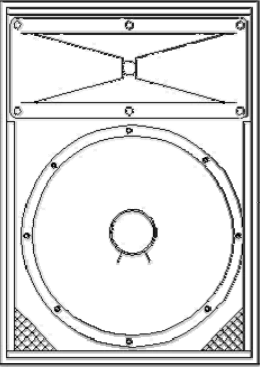
		<i>TS-15</i>	<i>TS-15BX</i>	<i>TS-15PC</i>
	Connector type	<i>4-pole Speakon</i>	<i>RJ-45</i>	<i>RJ-45</i>
Network interface	<i>Analogue Audio Input</i>	<i>Ethernet 10/100 Mbits</i>	<i>Ethernet 10/100 Mbits</i>	
Mode of operation	<i>Analogue audio</i>	<i>Interface with XA Series software</i>	<i>Stand alone or Interface with XA Series software</i>	
Built in power amplifier	<i>None</i>	<i>Twin Class D PWM</i>	<i>Twin Class D PWM</i>	
Power output	<i>None</i>	<i>High : 100W Low : 250W</i>	<i>High : 100W Low : 250W</i>	
Crossover	<i>Passive with Impedance correction</i>	<i>Optimized active crossover</i>	<i>Optimized active crossover</i>	
Loudspeaker driver	<i>1" tweeter & 15" woofer</i>	<i>1" tweeter & 15" woofer</i>	<i>1" tweeter & 15" woofer</i>	